



medoc

STL 350 · 390 · 430 · 480



FIXED TABLE OPTION SHOWN



medoc

STL 350 · 390 · 430 · 480

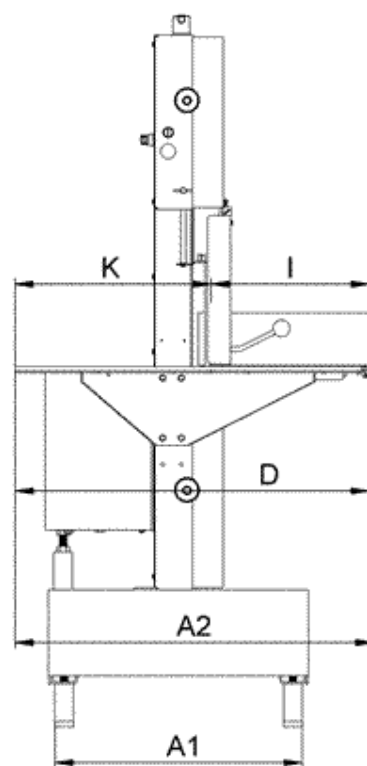
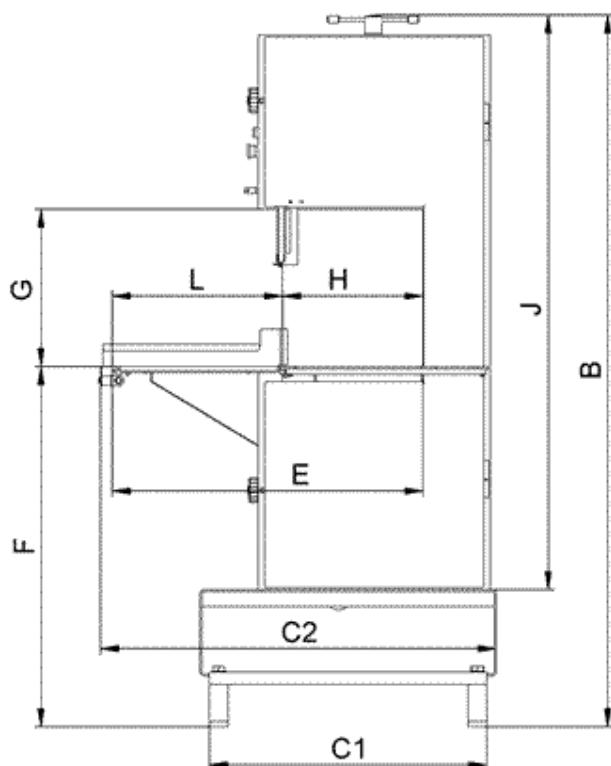

MOD (mm)	Ø Pulley	A1	A2	B	C1	C2	D	E	F	G	H	I	J	K	L	Kg.	H.P. III	Blade in mtr
STL - 350	300	625	790	1.670	610	745	775	604	900	350	275	322	1.485	453	329	155	3	2.500
STL - 390	360	625	845	1.780	700	930	830	739	900	400	335	357	1.595	473	404	190	4	2.910
STL-430	400	625	960	1.840	740	1.020	945	829	900	420	375	422	1.655	523	454	205	4	3.155
STL-480	450	625	960	1.950	810	1.090	945	879	900	480	425	422	1.765	523	454	235	5,5	3.500



MEDOC reserves the right to make any modification without prior notice.
Proudly supported by D.M.Dunningham LTD



BANDSAW STL 350 · 390 · 430 · 480



(2)



(1)



(5)



(6)

- Bandsaw for the meat and fish industries. Special robustness for large meat processing facilities and easy operating procedure.
- The design eases a good integration on the different lines of cutting process.
- Robust 18/10 stainless steel construction.
- Stainless steel pulleys with double flap.
- Automatic process of tension control.
- Safety device to stop running blade in 4 seconds.
- On-off switch with emergency stop button, IP65.
- Safety device when opening door.
- No volt release system.
- Manufacturing of blade on the right or left hand side
- Easy cleaning with water pressure.
- A one piece body construction to ease the cleaning on a uniform platform.
- Detachable cleaners for easy cleaning, without the use of tools.
- Scrapers for pulley cleaning during the cutting process.

TABLE OPTIONS: (Feet old model)

- **STL-F FIX TABLE (1).**
- **STL-M BEARING TABLE (2)**
Roller top table system.(3)
The roller top table converts to fix table easily. (4)
- **STL-R RAMP TABLE (5)**
Rod ramp table to cut slices. Lid for fix table.
- **STL-B BANKED TABLE (6)**
Banked table, to ease the product exit cut.



(3)

(4)